

Relax H

Recessed luminaire with louvers

Product description

Recessed luminaire with louvers is a popular choice for commercial applications. Louvers help to control the distribution of light, directing it downwards where it is needed most, also help to reduce glare, which can cause discomfort and eye strain. This is especially important in task areas, such as offices. With optional DALI control, you adjust lighting to individual preferences. With a lifespan exceeding 100,000 hours, it guarantees long-lasting and reliable performance.

Technical features:

- Optical system: matt parabolic louver PAR MAT-V2 (ML2)
- Housing: sheet steel
- Diffuser: PMMA
- Parabolic louver: matt anodised aluminium
- Chromaticity: 3-step MacAdam
- Colour rendering index: min. 80
- Colour temperature: 3000K, 4000K
- Electronic control gear: FIX (ECG), DALI (EDA), on request Emergency unit variant
- Service lifetime: 100,000 hours/L90/B10 (ta 25°C)
- Ambient temperature: Ta = -25°C...+35°C
- Degree of protection: IP20
- Dimensions: M 1200 x 112 x 61 mm, L 1500 x 112 x 61 mm
- Cutout: M 1180 x 100 mm, L 1480 x 100 mm

Photometry

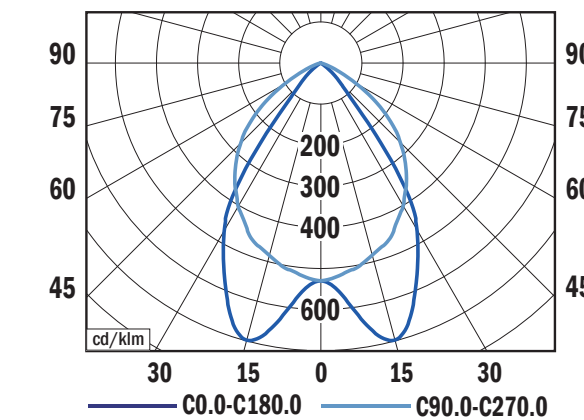

RELAX H M, 2650 lm 4000 K
LOR = 100%
lower flux fraction 100%
upper flux fraction 0%
UGR <16/<19

Dimensions

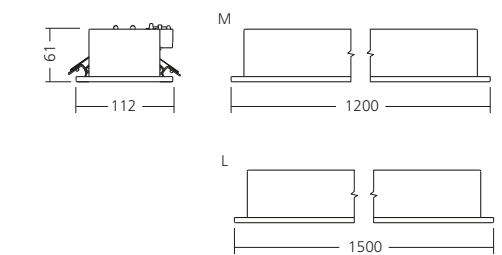

Mounting

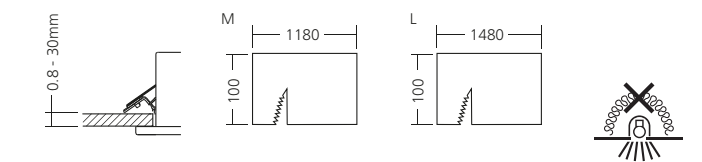

TYPE	NET LUMEN OUTPUT (at Ta = 25 °C) (lm)	POWER CONSUMPTION (W)	SYSTEM EFFICACY (lm/W)	COLOUR RENDERING INDEX	CORRELATED COLOUR TEMPERATURE (K)	BEAM ANGLE	WEIGHT (kg)
RELAX H M	2500	18	139	80+	3000	70°, 90°	2.3
RELAX H M	2650	18	147	80+	4000	70°, 90°	2.3
RELAX H M	4300	32	134	80+	3000	70°, 90°	2.3
RELAX H M	4500	32	141	80+	4000	70°, 90°	2.3
RELAX H L	5300	38	139	80+	3000	70°, 90°	2.9
RELAX H L	5550	38	146	80+	4000	70°, 90°	2.9
RELAX H L	6700	50	134	80+	3000	70°, 90°	2.9
RELAX H L	7050	50	141	80+	4000	70°, 90°	2.9

220-240V
50-60Hz

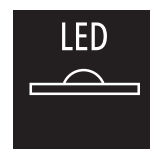

CHROMATICITY
3
SDCM

CRI
80+
Ra

CCT
3000
K

CCT
4000
K



EDA
DALI



IP
20

